

CARIBBEAN PRINCESSSM

The magnificent Caribbean PrincessSM is a wonderful way to experience this region. This stunning ship brings you the best of its destinations from nearly 900 balcony staterooms. Spend leisurely days getting treatments in the luxurious Lotus Spa[®], shopping in the duty-free boutiques and relaxing by four refreshing pools. You'll delight in wonderful Traditional or Anytime DiningSM, or specialty offerings at Sabatini'sSM. And make the most of warm evenings with our famous Movies Under the Stars[®].



		DECK
SHIP FACTS		- • Accommodates 3,100 passengers
		- • Nearly 900 balcony staterooms
		- • An entire deck of mini-suites
		- • 952 feet in length
		- • 113,000 gross tons
PERSONAL CHOICE DINING [®]	TRADITIONAL	6 • Palm Dining Room
	ANYTIME	5 • Island Dining Room
		6 • Coral Dining Room
	SPECIALTY	7 • Sabatini's SM (Italian restaurant)
		7 • Sterling Steakhouse SM
		- • Ultimate Balcony Dining
	CASUAL	5 • Lobby Bar and Patisserie
		7 • Wine Bar
		15 • Café Caribe
		15 • Prego Pizzeria
	15 • Trident Grill (burgers and hot dogs)	
	15 • Scoops Ice Cream Bar	
	15 • 24-hour dining in the Horizon Court	
	† • Afternoon tea	
	- • 24-hour room service	
ENTERTAINMENT	THEATERS	6/7 • Princess Theater
		16 • Movies Under the Stars [®] (outdoor theater)
	HOT SPOTS	6 • Grand Casino
		7 • Explorers Lounge (nightclub-style performances)
		7 • Club Fusion
	18/19 • Skywalkers Nightclub	
LOUNGES & BARS		5 • Jokers Card Room
		6 • Churchill Lounge
		7 • Crooners Bar
		7 • Wheelhouse Bar
ACTIVITIES	POOLS	14 • Terrace Pool
		15 • Calypso Reef and Pool (includes 2 hot tubs)
		15 • Neptune's Reef and Pool (includes 2 hot tubs)
		16 • Lotus Spa [®] Pool
		17 • Pirate's View hot tub and splash pool
	SPORTS & SPA	16 • Lotus Spa [®] gym and fitness area
		16 • Swim-against-the-current lap pool
		17 • Center Court
		17 • Digital golf simulators
		17 • Jogging Track
	17 • Shuffleboard	
	19 • Nine-hole putting course	
ENRICHMENT	† • ScholarShip@Sea [®]	
	5 • Library and writing room	
	7 • 24-hour Internet Café (wireless access)	
SHOPPING	5 • World-class art collection, gallery and auctions	
	6 • Future Cruise Sales	
	6/7 • Boutiques (duty-free)	
	16 • Hearts & Minds Wedding Chapel	
UNDER 18	KIDS & TEENS	6 • Video Arcade
		16 • Teen Center
		16 • Youth Center
		16 • Splash pool

† Location may vary.

EARLY BOOKING DISCOUNT • 7-DAY SAILINGS FROM \$479 PER PERSON

CARIBBEAN PRINCESS STATEROOMS

Our spacious staterooms are designed with your enjoyment in mind. Each room includes a refrigerator, TV, hair dryer, a personal safe for your convenience, and plush European-style duvets with luxury 100% Egyptian cotton bed linens. Plus, the following amenities for the category of your choice:

GRAND SUITE WITH BALCONY

Our grand suite is extra spacious with a large balcony and panoramic views. It includes all the premium amenities of a suite with balcony plus the following upgrades: deluxe queen mattress, spacious sitting room, convertible sofa double bed, large walk-in closet, personal computer and corner tub equipped with whirlpool jets and multi-directional shower. Approximately 1,277 square feet, including balcony. (Category GS)

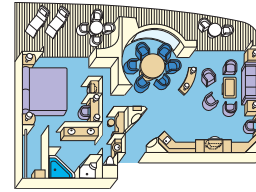

Grand suite with balcony

SUITE WITH BALCONY

Surrounding you with luxurious accommodations, a spacious suite with balcony includes all the amenities of a mini-suite, plus incredible premiums. These include luxury balcony furniture, deluxe canapés, fresh flowers, DVD/CD player, free access to a DVD library, one complimentary mini-bar setup, a roomy walk-in closet, upgraded bathroom amenities and complimentary use of the Lotus Spa® Thermal Suite, laundry and dry cleaning services, and web access in the Internet Café. Approximately 461 to 687 square feet, including balcony. (Categories OS, PH, PS & VS)

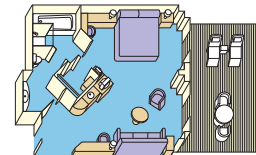

Mini-suite with balcony

MINI-SUITE WITH BALCONY

A mini-suite with balcony is substantially larger than a balcony stateroom. It includes all the amenities of a balcony stateroom and these added luxuries: welcome glass of champagne, separate sitting area, sofa bed, luxury mattress and pillows, two TVs, a spacious closet, desk, bathroom tub and massage shower head. Approximately 323 square feet, including balcony. (Categories AA, AB, AC, AD & AE)

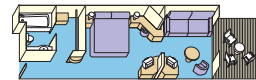

OCEANVIEW DOUBLE WITH BALCONY

This impressive stateroom offers the elegance of a balcony with fine patio furniture. Other amenities include a spacious closet, desk and a bathroom with shower. Approximately 233 to 285 square feet, including balcony. (Categories BA, BB, BC, BD, BE, BF & BG)

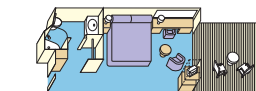

Oceanview double

OCEANVIEW DOUBLE (NOT SHOWN)

Our oceanview stateroom includes all the amenities of an interior double, plus it features a picture window, providing added ambience and memorable views. Approximately 158 to 181 square feet. (Categories C, DD, D, EE, E, FF, F, GG & G; Category C has portholes; Categories E-G have partially to fully obstructed views)

INTERIOR DOUBLE (NOT SHOWN)

Our interior stateroom is a great value. It features two twin beds that make up into a queen-size bed. Other amenities include a refrigerator, TV, closet and bathroom with shower. Approximately 160 square feet. (Categories II, I, JJ, J, KK, K, L & M)

Note: Family suite (category XS) not shown. Floor plans and stateroom diagrams represent typical arrangements. Certain staterooms may vary in size and configuration. Square footage varies based on stateroom category and deck location. Call 1-800-PRINCESS for more information.

CARIBBEAN PRINCESS DECK PLANS

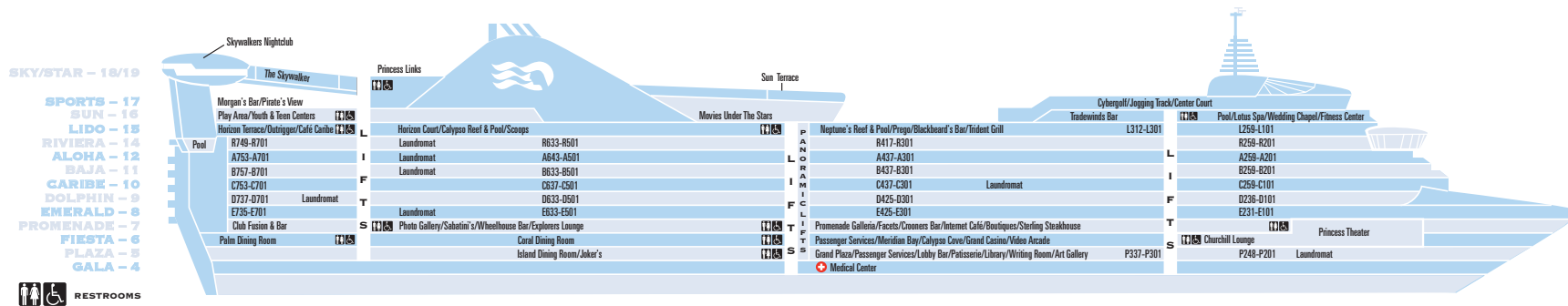

← AFT

FORWARD →

Sky/Star 18/19

Sports 17

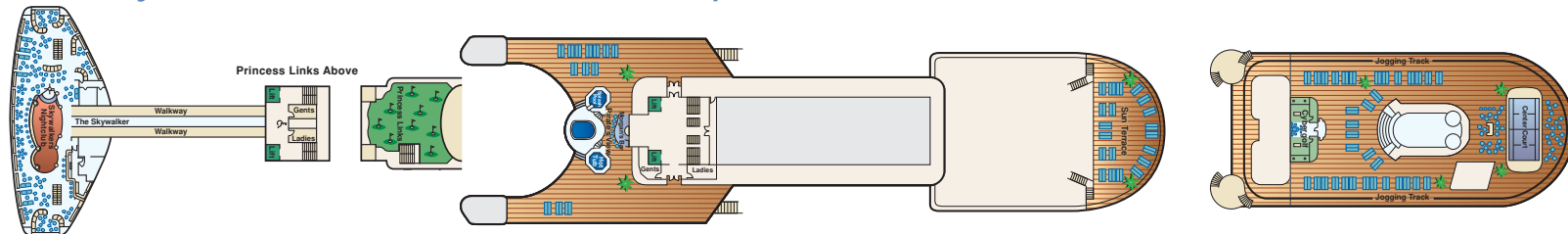

Sun 16

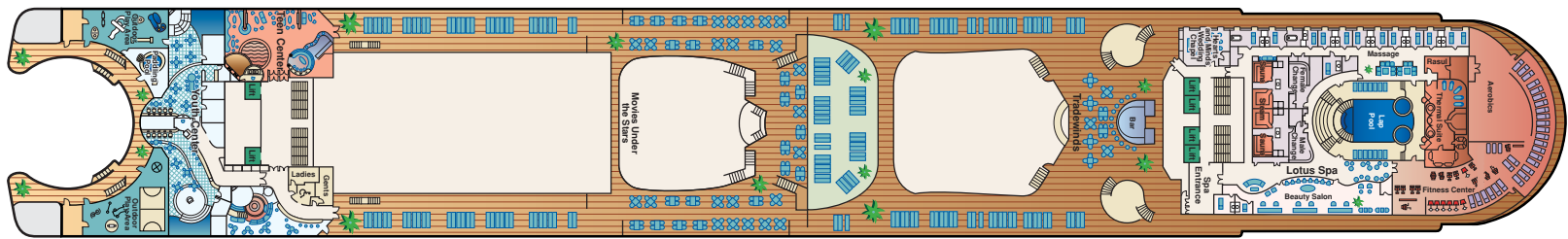

Lido 15

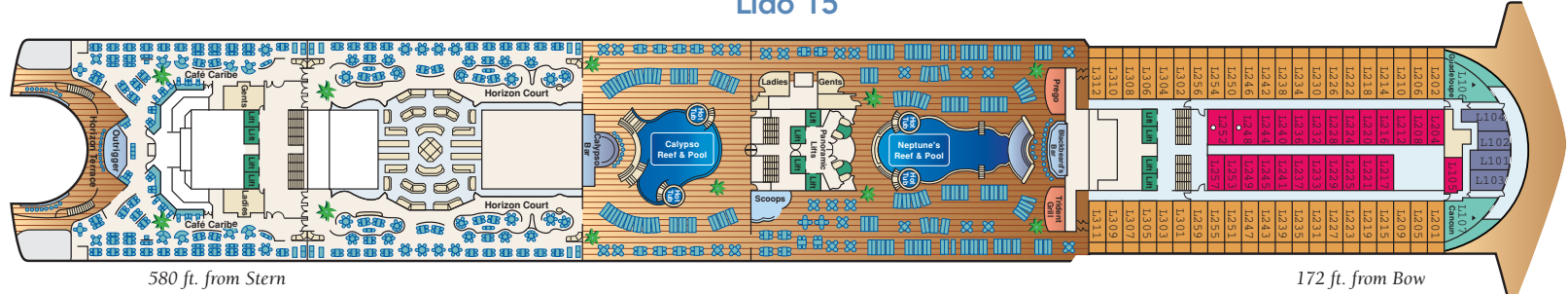

580 ft. from Stern

172 ft. from Bow

Distances shown are from the bow (forward) or stern (aft) to the nearest stateroom.

CARIBBEAN PRINCESS DECK PLANS

← AFT

FORWARD →

Riviera 14

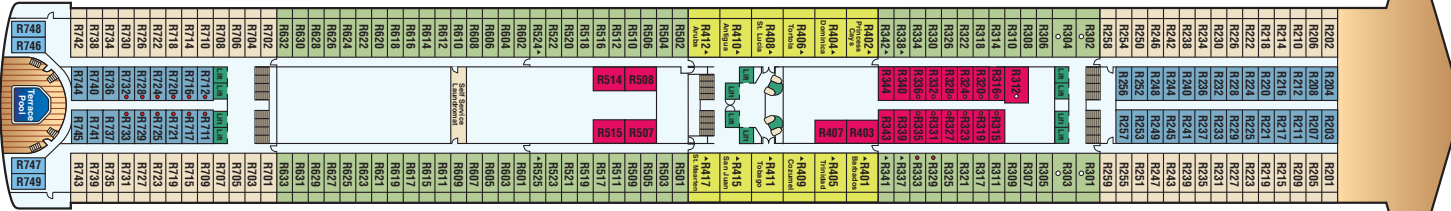

20 ft. from Stern

172 ft. from Bow

Aloha 12

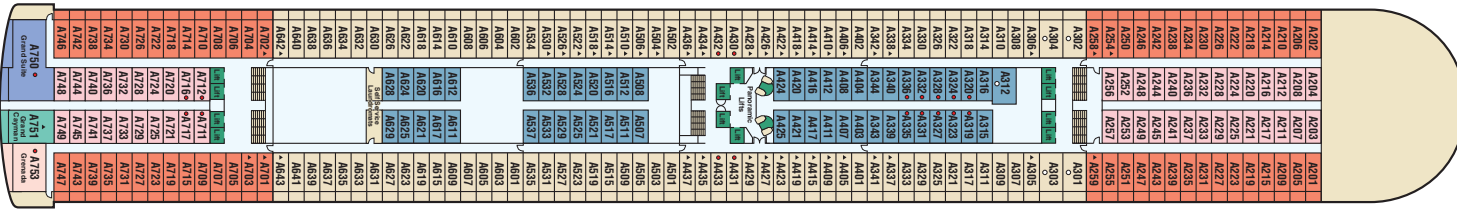

11 ft. from Stern

172 ft. from Bow

Baja 11

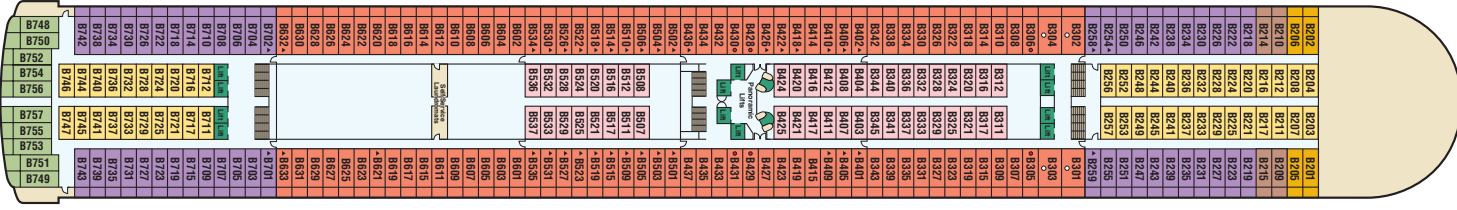

14 ft. from Stern

172 ft. from Bow

Caribe 10

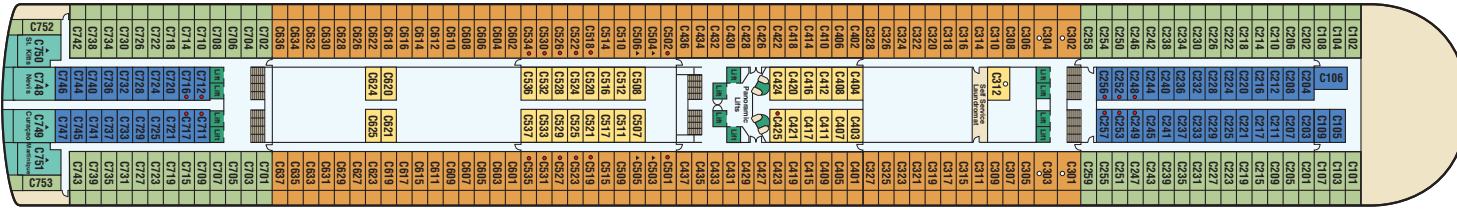

14 ft. from Stern

172 ft. from Bow

Dolphin 9

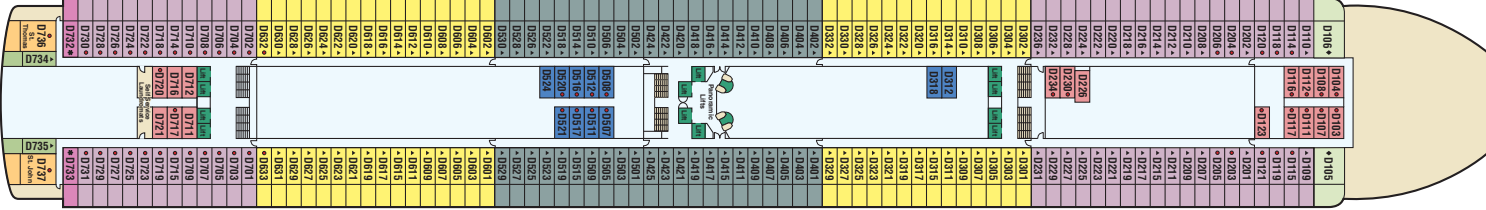

20 ft. from Stern

117 ft. from Bow

CARIBBEAN PRINCESS DECK PLANS

← AFT

FORWARD →

Emerald 8

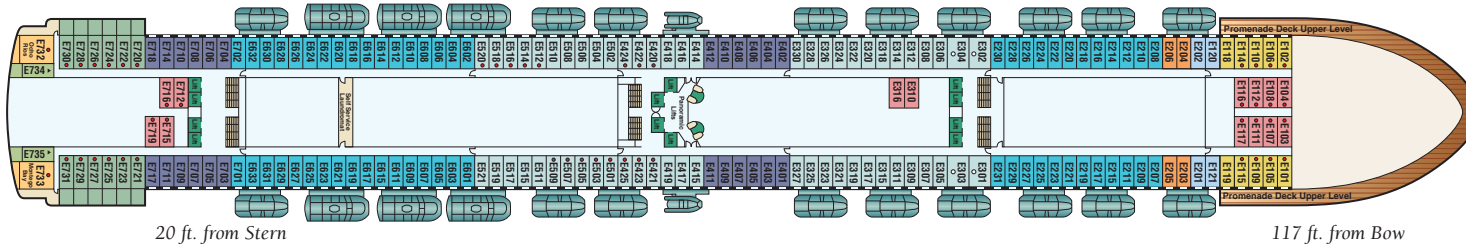

Promenade 7

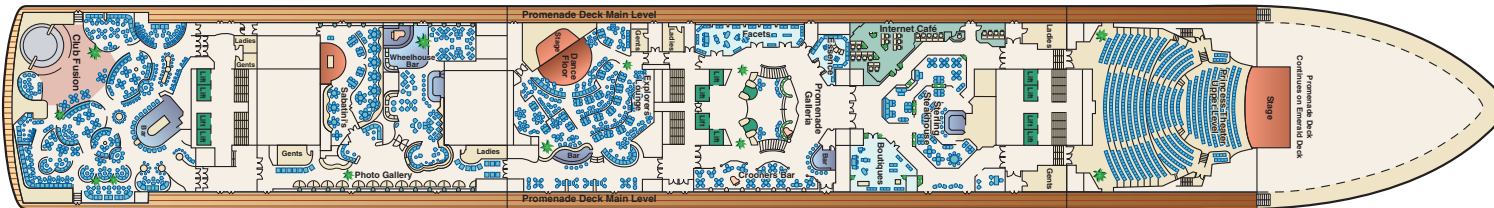

Fiesta 6

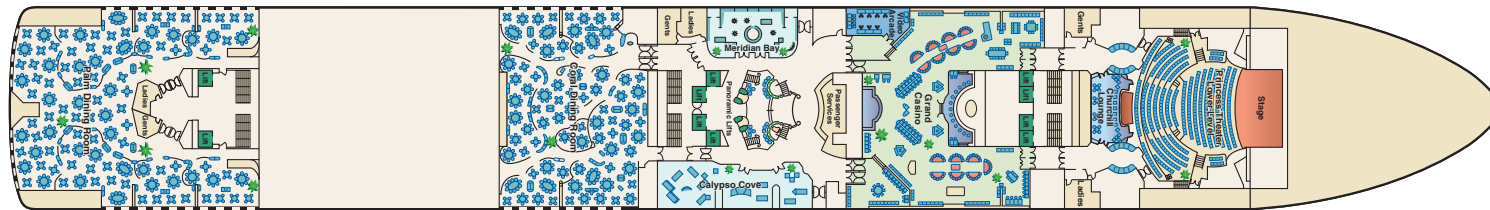

Gala 4

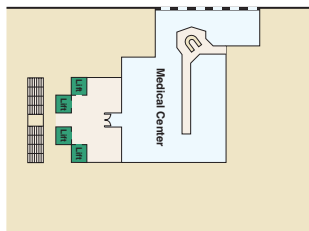

Plaza 5

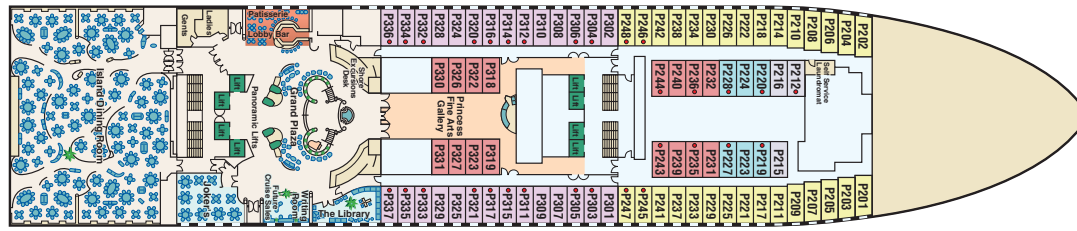

STATEROOM DESCRIPTION

- GS ALOHA:** Grand suite with queen-size bed and balcony
- OS ALOHA:** Owner's suite with balcony
- PH RIVIERA:** Penthouse suite with balcony
- P5 ALOHA, CARIBE, LIDO:** Premium suite with balcony
- VS DOLPHIN, EMERALD:** Vista suite with balcony
- XS DOLPHIN:** Family suite: interconnecting staterooms with balcony
- AA DOLPHIN:** Mini-suite with balcony
- AB DOLPHIN:** Mini-suite with balcony
- AC DOLPHIN:** Mini-suite with balcony
- AD EMERALD:** Mini-suite with balcony
- AE DOLPHIN:** Mini-suite with balcony
- BA CARIBE, LIDO:** Balcony two lower beds
- BB BAJA, CARIBE, DOLPHIN, EMERALD, RIVIERA:** Balcony two lower beds
- BC ALOHA, RIVIERA:** Balcony two lower beds
- BD ALOHA, BAJA:** Balcony two lower beds
- BE BAJA:** Balcony two lower beds
- BF BAJA:** Balcony two lower beds
- BG BAJA:** Balcony two lower beds
- C RIVIERA:** Oceanview two lower beds (portholes)
- DD EMERALD:** Oceanview two lower beds
- D PLAZA:** Oceanview two lower beds
- EE PLAZA:** Oceanview two lower beds
- E EMERALD, LIDO:** Oceanview two lower beds (partially obstructed view)
- FF EMERALD:** Oceanview two lower beds (obstructed view)
- F EMERALD:** Oceanview two lower beds (obstructed view)
- GG EMERALD:** Oceanview two lower beds (obstructed view)
- G EMERALD:** Oceanview two lower beds (obstructed view)
- H LIDO, RIVIERA:** Interior two lower beds
- I ALOHA, RIVIERA:** Interior two lower beds
- J ALOHA, BAJA:** Interior two lower beds
- J BAJA, CARIBE:** Interior two lower beds
- KK CARIBE, DOLPHIN:** Interior two lower beds
- K DOLPHIN, EMERALD, PLAZA:** Interior two lower beds
- L PLAZA:** Interior two lower beds
- M PLAZA:** Interior two lower beds

visit princess.com for virtual tours and photos of staterooms

♦ Family suites D105/D101 and D106/D102: Interconnecting staterooms with private balcony; accommodates up to eight persons (D101 and D102 not shown separately)
 ° Wheelchair-accessible stateroom ♦ Will accommodate third and fourth person ▲ Will accommodate third person * Two lower beds not convertible to queen; shower only
 Note: Some areas of the ship are not accessible to wheelchairs and scooters.